



City of Wheat Ridge Survey Monument

City Designation: POINT 16909

Monument Description: Center 1/4 Corner Section 25, T3S, R69W, of the 6th Principal Meridian.

(SPCS) State Plane Coordinate System, Colorado Central
FIPZONE: 502 **ADZONE:** 3476 **UTM ZONES:** 12 & 13
State/County: Colorado/Jefferson

Colorado Land Survey Master Index Number: 23-G

Horizontal Datum: NAD 83/92 – HARN (High Accuracy Reference Network) Based
Ellipsoid: WGS 84 – (World Geodetic System of 1984)
Vertical Datum: NAVD 88 – (North American Vertical Datum of 1988)
NGS Unpublished (City of Wheat Ridge Surveyed Point)
Combined Factors: 0.999747803 (ground to grid)
1.00025226062 (grid to ground - City Datum)

	<u>Northing</u>	<u>Easting</u>	
<u>SPCS:</u>	1702764.5220	3122952.6805	
<u>City Datum:</u>	703194.0624	123740.4785	(Millions truncated in City Datum)
<u>Height:</u>	5455.11	US Feet (Adjusted)	

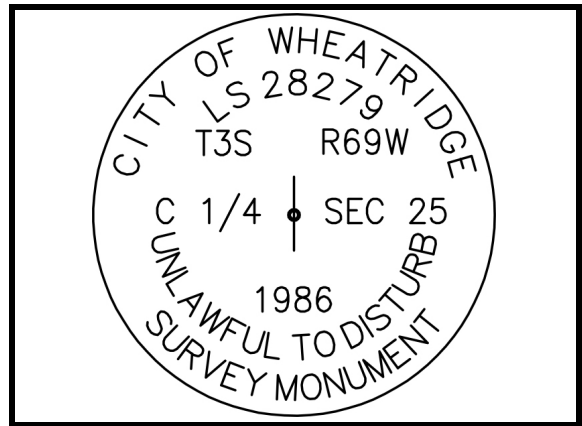

The monument is located in the City of Wheat Ridge, Colorado in the intersection of W. 32nd Ave. and Harlan St.