

Back-in Angle Parking

The restriping of 38th Avenue between Upham and Depew Streets will include the addition of on-street parking on one side of the street. Most of the corridor will receive parallel parking. For about 1.5 blocks between Teller Street and High Court, the existing pavement is wide enough to add angle, or diagonal, parking. The City is considering piloting back-in angle parking for this 1.5 block stretch.

Back-in parking is similar to parallel parking and standard head-in angle parking. As with parallel parking, the driver enters the parking space by stopping and reversing. When leaving the stall, the driver can simply pull out and has a better view of the oncoming traffic, which is especially important where there is a bike lane (the portion of 38th Ave considered for reverse angle parking will have a bike lane). Back-in angle parking is currently utilized in multiple cities and towns throughout the United States, including Colorado Springs.

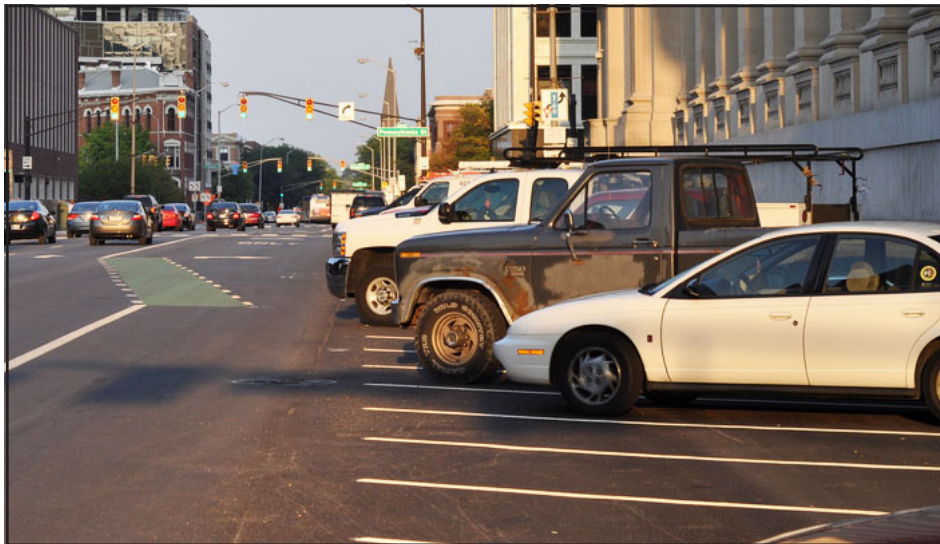

Above: back-in angle parking in Indianapolis, Indiana

Advantages of Back-in Angle Parking:

- Better visibility for drivers when leaving the parking space, even if you are parked next to a large vehicle.
- Eye-to-eye line of sight between the parker and the approaching vehicle or bicyclist.
- Reduces accidents involving oncoming motorists and bicyclists.
- Allows quicker entry into traffic flow.
- Simpler than a parallel parking maneuver.
- Allows for easy loading from the sidewalk into the trunk.
- Drivers can open their door and unload away from the flow of traffic.

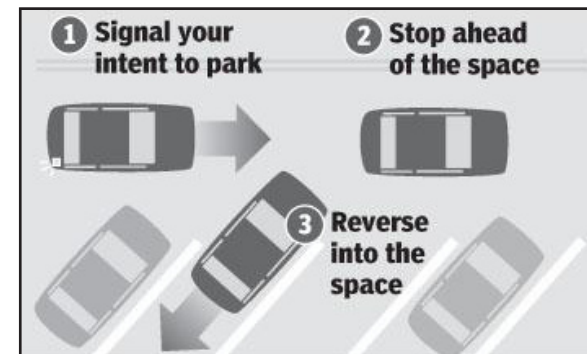

Source: Roberto Villalpando, American Statesman

Questions? Contact:

Sarah Showalter, Planner II: 303-235-2849

sshowalter@ci.wheatridge.co.us

Mark Westberg, Projects Engineer: 303-235-2863

mwestberg@ci.wheatridge.co.us

Download a complete copy of the 38th Avenue Corridor Plan:

www.ci.wheatridge.co.us/38thAve